



# NORDEN SYSTEMS 12 Bale Flat

Well-suited for filling a  
9' x 20' wagon

A popular choice for accumulating  
bales on their strings

Same bale group footprint  
as the AE15

## AF12 Accumulator

- Sets bales down on strings in groups of 4 bales wide and 3 bales long
- Handles 14" x 18" bales 32-40" long

**Shipping Dimensions**  
21'2"L x 7'10" W x 5'7"H

**Working Dimensions**  
21'1"L x 7'10" W x 11'1"H

**Approximate Weight**  
2290 lb

**Group Size**  
72"W by 96-132"L

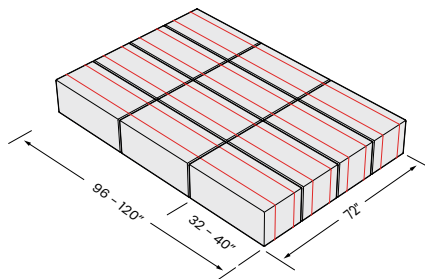

# NORDEN SYSTEMS

# 12 Bale Flat

## 612F Grabber



- Picks up the bales 4 wide and 3 long on their strings using 24 hooks on 6 bars
- Handles 14" x 18" and 16" x 18" bales 32–36" long\*
- Requires loader with 1800 lb lift capacity\*\*

### Shipping Dimensions

105"L x 72"W x 22"H

### Working Dimensions

95"L x 72"W

### Approximate Weight

760 lb

### Lift Capacity Requirement\*\*

1800 lb

## KN612F Tie-Grabber



- Picks up the bales 4 wide and 3 long on their strings using 24 hooks on 6 bars
- Handles 14" x 18" and 16" x 18" bales 32–36" long\*
- Requires loader with 2300 lb lift capacity\*\*

### Shipping Dimensions

109"L x 78"W x 30"H

### Working Dimensions

95"L x 72"W

### Approximate Weight

1460 lb

### Lift Capacity Requirement\*\*

2300 lb

## SQ102 Squeeze

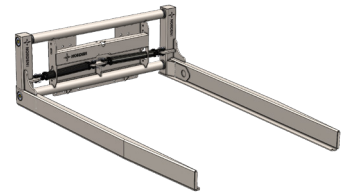

**WORKS WITH**

- Picks up tied bundles that are 4, 5, or 6 bales wide and 3 bales long
- For maximum efficiency, it is recommended to pick up as many bales as the loader can safely handle
- 4000 lb max lift capacity\*

### Shipping Dimensions

107"L x 74"W x 29"H

### Working Dimensions

101"L x 67.5–103.5"W x 29"H

### Approximate Weight

1060 lb

### Group Size

72–90"W x 96–108"L

### Lift Capacity Requirement

4000 lb



(877) 296-5851  
nordenmfg.com

\* With no adjustments. An extended version is available for bales longer than 36".

\*\* Lift capacity is an estimate based on an average bale weight of 40–50 pounds. However, it is up to the individual to determine their specific loader requirements.