



NORDEN SYSTEMS

10 Bale Flat

The arrangement of 2.5 rows of bales fits perfectly on a 8' wagon side-to-side

Our most popular accumulator

Well suited for small farms

The tie row allows for cross-stacking on wagon with the KN510F tie-grabber or 510F grabber for a more stable load

AF10 Accumulator

- Sets bales down on strings in groups of 4 bales wide and 2 bales long and two tie bales turned sideways to the rest of the group.
- Handles 14" x 18" bales 32-38" long

Shipping Dimensions
18'11"L x 7'10"W x 5'7"H

Working Dimensions
18'10"L x 7'10"W x 10'1"H

Approximate Weight
2240 lb

Group Size
64-76"W x 82-94"L

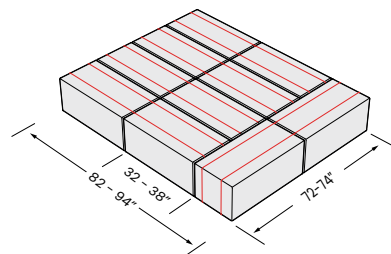

NORDEN SYSTEMS

10 Bale Flat

510F Grabber



- Picks up the bales on their strings 4 wide and 2 long, plus a tie row with 2 bales turned sideways, using 22 hooks on 5 bars
- Handles 14" x 18" and 16" x 18" bales 32-38" long*
- Requires loader with 1700 lb lift capacity**

Shipping Dimensions

100"L x 72"W x 22"H

Working Dimensions

90"L x 72"W

Approximate Weight

740 lb

Lift Capacity Requirement**

1700 lb

KN510F Tie-Grabber

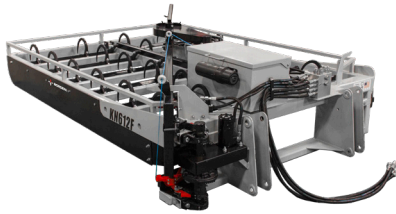

- Picks up the bales on their strings 4 wide and 2 long, plus a tie row with 2 bales turned sideways, using 22 hooks on 5 bars
- Handles 14" x 18" and 16" x 18" bales 32-38" long*
- Requires loader with 1900 lb lift capacity**

Shipping Dimensions

104"L x 78"W x 30"H

Working Dimensions

90"L x 72"W

Approximate Weight

1440 lb

Lift Capacity Requirement**

1900 lb

SQ90 Squeeze

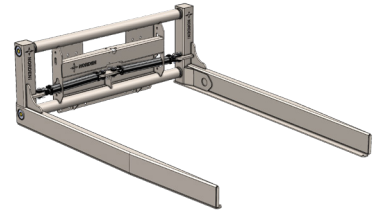

WORKS WITH

- Picks up tied bundles that are 4, 5, or 6 bales wide and 2 bales long
- For maximum efficiency, it is recommended to pick up as many bales as the loader can safely handle
- 4000 lb max lift capacity*

Shipping Dimensions

95"L x 74"W x 29"H

Working Dimensions

89"L x 67.5-103.5"W x 29"H

Approximate Weight

1020 lb

Group Size

72-90"W x 96-108"L

Lift Capacity Requirement

4000 lb



(877) 296-5851
nordenmfg.com

* With no adjustments. An extended version is available for bales longer than 36".

** Lift capacity is an estimate based on an average bale weight of 40-50 pounds. However, it is up to the individual to determine their specific loader requirements.