



# NORDEN SYSTEMS

## 10 Bale Flat

The arrangement of 2.5 rows of bales fits perfectly on a 8' wagon side-to-side

Our most popular accumulator

Well suited for small farms

The tie row allows for cross-stacking on wagon with the KN510F tie-grabber or 510F grabber for a more stable load

### AF10 Accumulator

- Sets bales down on strings in groups of 4 bales wide and 2 bales long and two tie bales turned sideways to the rest of the group.
- Handles 14" x 18" bales 32-38" long

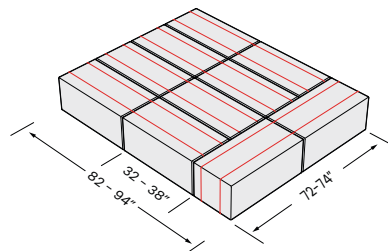

#### Shipping Dimensions

18'11"L x 7'10"W x 5'7"H

#### Working Dimensions

18'10"L x 7'10"W x 10'1"H

#### Approximate Weight

2240 lb

#### Group Size

64-76"W x 82-94"L

# NORDEN SYSTEMS

## 10 Bale Flat

### 510F Grabber



- Picks up the bales on their strings 4 wide and 2 long, plus a tie row with 2 bales turned sideways, using 22 hooks on 5 bars
- Handles 14" x 18" and 16" x 18" bales 32-38" long\*
- Requires loader with 1700 lb lift capacity\*\*

#### Shipping Dimensions

100"L x 72"W x 22"H

#### Working Dimensions

90"L x 72"W

#### Approximate Weight

740 lb

#### Lift Capacity Requirement\*\*

1700 lb

### KN510F Tie-Grabber

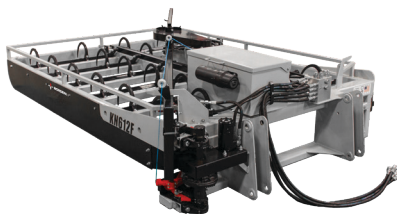

- Picks up the bales on their strings 4 wide and 2 long, plus a tie row with 2 bales turned sideways, using 22 hooks on 5 bars
- Handles 14" x 18" and 16" x 18" bales 32-38" long\*
- Requires loader with 1900 lb lift capacity\*\*

#### Shipping Dimensions

104"L x 78"W x 30"H

#### Working Dimensions

90"L x 72"W

#### Approximate Weight

1440 lb

#### Lift Capacity Requirement\*\*

1900 lb

### SQ90 Squeeze

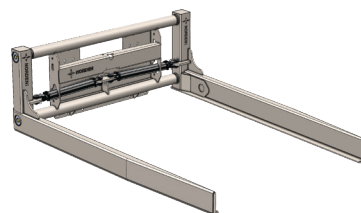

WORKS  
WITH

- Picks up tied bundles that are 4, 5, or 6 bales wide and 2 bales long
- For maximum efficiency, it is recommended to pick up as many bales as the loader can safely handle
- 4000 lb max lift capacity\*

#### Shipping Dimensions

95"L x 74"W x 29"H

#### Working Dimensions

89"L x 67.5-103.5"W x 29"H

#### Approximate Weight

1020 lb

#### Group Size

72-90"W x 96-108"L

#### Lift Capacity Requirement

4000 lb



877-296-5851  
nordenmfg.com

\* With no adjustments. An extended version is available for bales longer than 36".

\*\* Lift capacity is an estimate based on an average bale weight of 40-50 pounds. However, it is up to the individual to determine their specific loader requirements.